



## HSK T63 (TURN MILL-MULTI TASK)



# 2023 Catalog

World-class products

Precise quality

Satisfied customer



# HSK T63 (TURN MILL-MULTI TASK)

## Table of contents

Description	Page
<b>TURNING TOOL</b>	
<b>EXTERNAL TURNING TOOL-TOP CLAMP</b> .....	4
DCM12DDM15.....	4
DDMNL.....	4
DCMNN.....	4
DDNNN.....	4
<b>EXTERNAL TURNING TOOL-LEVER CLAMP</b> .....	5
PCLN.....	5
PDJN.....	5
PCMNN.....	5
PDNNN.....	5
<b>EXTERNAL TURNING TOOL-SCREW CLAMP</b> .....	6
SCLC.....	6
SDJC.....	6
SDNCN.....	6
SVVCN.....	6
SVHC.....	7
SVJC.....	7
SVJB.....	7
<b>INTERNAL BORING BARS-LEVER CLAMP</b> .....	8
PCLN.....	8
PDUN.....	8
<b>INTERNAL BORING BARS-SCREW CLAMP</b> .....	8
SCLC.....	8
SDUC.....	9
SVQB.....	9
<b>ADAPTOR FOR SHANK TOOLS</b>	
<b>AXIAL MOUNTING</b> .....	10
SPARES-SHIM.....	10
<b>RADIAL MOUNTING</b> .....	10
SPARES-WEDGES.....	10
<b>ANGULAR MOUNTING 45°</b> .....	11
SPARES-WEDGES.....	11
<b>AXIAL COMBINED MOUNTING</b> .....	11
SPARES-SHIM.....	11
<b>ADAPTORS FOR BORING BARS</b>	
<b>INDEXABLE DRILL/EM HOLDERS</b> .....	12
<b>BORING BAR HOLDERS</b> .....	12
<b>BORING BAR HOLDERS FOR DAMPED TOOLS</b> .....	12

# HSK T63 (TURN MILL-MULTI TASK)

TURNING TOOL

## EXTERNAL TURNING TOOL-TOP CLAMP

### DCM12DDM15

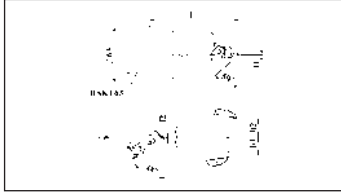
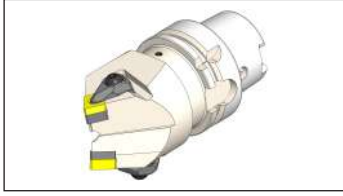

Part No.	Product name	L	f1	h1	f2	h2	Inserts 1	Inserts 2	Group
F1T063X-DDCM1215100	HSK T63 DCM12DDM15 100	100	0.9	20	0.9	20	CN.120408	DN.150608	D9900
F1T063X-DDCM1215145	HSK T63 DCM12DDM15 145	145	0.9	20	0.9	20	CN.120408	DN.150608	D9900

### DDMNL

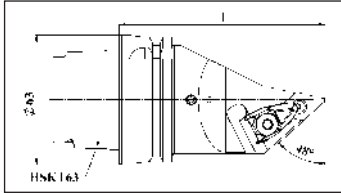
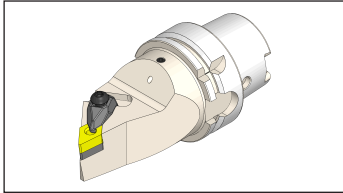

Part No.	Product name	L	Inserts	Group
F1T063X-DDMNL015100	HSK T63 DDMNL 15 100	100	DN.150608	D9900
F1T063X-DDMNL015145	HSK T63 DDMNL 15 145	145	DN.150608	D9900

### DCMNN

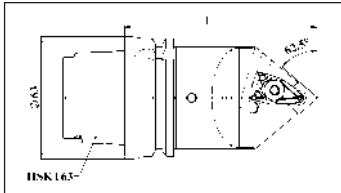

Part No.	Product name	L	Inserts	Group
F1T063X-DCMNN012090	HSK T63 DCMNN 12 090	90	CN.120408	D9900
F1T063X-DCMNN012100	HSK T63 DCMNN 12 100	100	CN.120408	D9900
F1T063X-DCMNN012145	HSK T63 DCMNN 12 145	145	CN.120408	D9900

### DDNNN

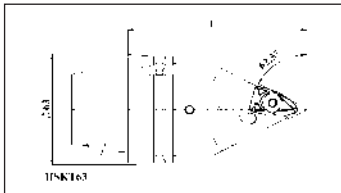

Part No.	Product name	L	Inserts	Group
F1T063X-DDNNN015090	HSK T63 DDNNN 15 090	90	DN.150608	D9900
F1T063X-DDNNN015100	HSK T63 DDNNN 15 100	100	DN.150608	D9900
F1T063X-DDNNN015145	HSK T63 DDNNN 15 145	145	DN.150608	D9900

# HSK T63 (TURN MILL-MULTI TASK)

## EXTERNAL TURNING TOOL-LEVER CLAMP

### PCLN



Note: Above shown images are Left Hand

Part No.	Product name	l.	f.	Inserts	Group
F1T063X-PCLNL012070	HSK T63 PCLNL 12 070	70	45	CNM.120408	D9900
F1T063X-PCLNR012070	HSK T63 PCLNR 12 070	70	45	CNM.120408	D9900

### PDJN



Note: Above shown images are Left Hand

Part No.	Product name	l.	f.	Inserts	Group
F1T063X-PDJNL015070	HSK T63 PDJNL 15 070	70	45	DNM.150608	D9900
F1T063X-PDJNR015070	HSK T63 PDJNR 15 070	70	45	DNM.150608	D9900

### PCMNN

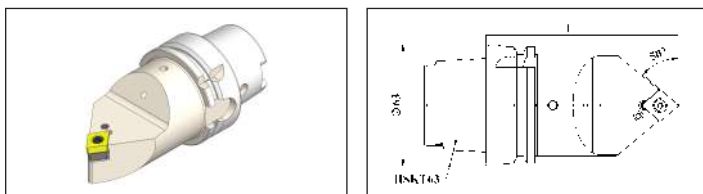

Part No.	Product name	l.	Inserts	Group
F1T063X-PCMNN012090	HSK T63 PCMNN 12 090	90	CN.120408	D9900
F1T063X-PCMNN012100	HSK T63 PCMNN 12 100	100	CN.120408	D9900
F1T063X-PCMNN012145	HSK T63 PCMNN 12 145	145	CN.120408	D9900

### PDNNN

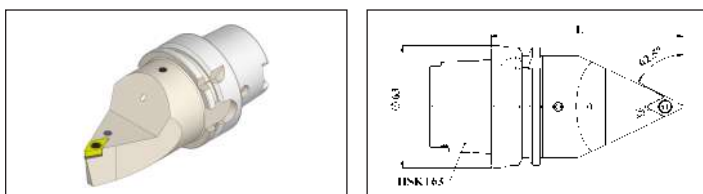

Part No.	Product name	l.	Inserts	Group
F1T063X-PDNNN015090	HSK T63 PDNNN 15 090	90	DN.150608	D9900
F1T063X-PDNNN015100	HSK T63 PDNNN 15 100	100	DN.150608	D9900
F1T063X-PDNNN015145	HSK T63 PDNNN 15 145	145	DN.150608	D9900

# HSK T63 (TURN MILL-MULTI TASK)

TURNING TOOL

## EXTERNAL TURNING TOOL-SCREW CLAMP

### SCLC



Note: Above shown images are Left Hand

Part No.	Product name	l.	f.	Inserts	Group
F1T063X-SCLCL012070	HSK T63 SCLCL12 070	70	45	CC.120408	D9900
F1T063X-SCLCR012070	HSK T63 SCLCL12 070	70	45	CC.120408	D9900

### SDJC

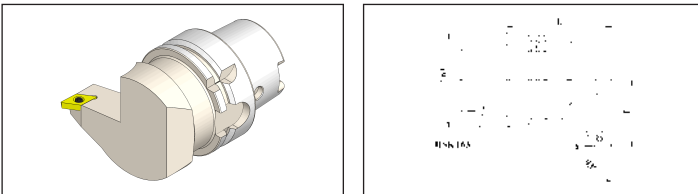

Note: Above shown images are Left Hand

Part No.	Product name	l.	f.	Inserts	Group
F1T063X-SDJCL011070	HSK T63 SDJCL 11 070	70	45	DC.11T308	D9900
F1T063X-SDJCR011070	HSK T63 SDJCR 11 070	70	45	DC.11T308	D9900

### SDNCN

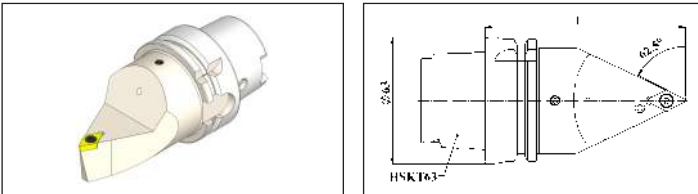

Part No.	Product name	l.	Inserts	Group
F1T063X-SDNCN011145	HSK T63 SDNCN 11 145	145	DC.11T308	D9900

### SVVCN

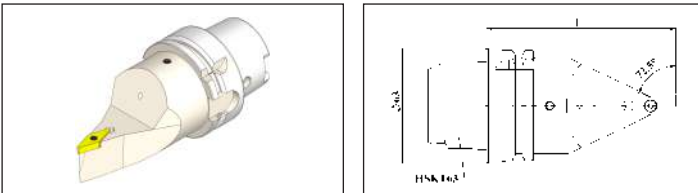

Part No.	Product name	l.	Inserts	Group
F1T063X-SVVCN016090	HSK T63 SVVCN 16 090	90	VC.160408	D9900
F1T063X-SVVCN16145	HSK T63 SVVCN 16 145	145	VC.160408	D9900

# HSK T63 (TURN MILL-MULTI TASK)

## SVHC

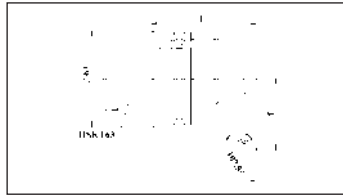
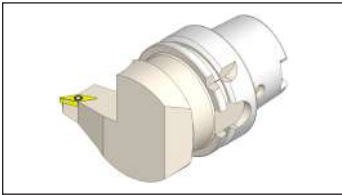

Note: Above shown images are Left Hand

Part No.	Product name	l.	f.	Inserts	Group
F1T063X-SVHCL016070	HSK T63 SVHCL 16 070	70	45	VC.160408	D9900
F1T063X-SVHCR016070	HSK T63 SVHCR 16 070	70	45	VC.160408	D9900

## SVJC

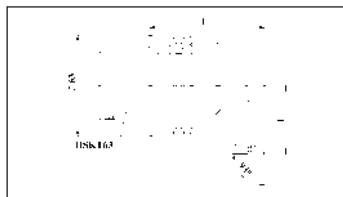
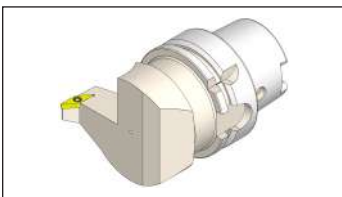

Note: Above shown images are Left Hand

Part No.	Product name	l.	f.	Inserts	Group
F1T063X-SVJCL016075	HSK T63 SVJCL 16 075	75	45	VC.160408	D9900
F1T063X-SVJCR016075	HSK T63 SVJCR 16 075	75	45	VC.160408	D9900

## SVJB

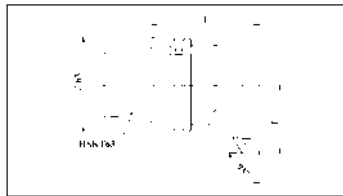
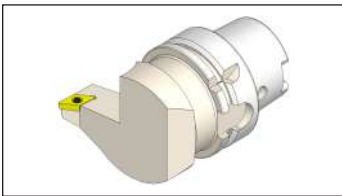

Note: Above shown images are Left Hand

Part No.	Product name	l.	f.	Inserts	Group
F1T063X-SVJBL016075	HSK T63 SVJBL 16 075	75	45	VB.160408	D9900
F1T063X-SVJBR016075	HSK T63 SVJBR 16 075	75	45	VB.160408	D9900

# HSK T63 (TURN MILL-MULTI TASK)

TURNING TOOL

## INTERNAL BORING BARS-LEVER CLAMP

### PCLN

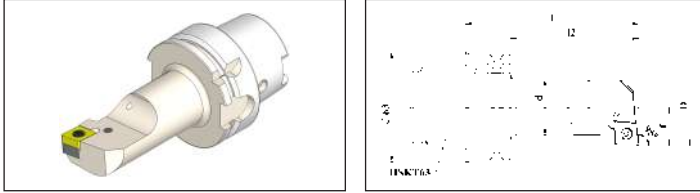

Note: Above shown images are Left Hand

Part No.	Product name	d.	l.	L2	f.	D	Inserts	Group
F1T063X-PCLNLI12100	HSK T63 PCLNL 12 100-INTERNAL	25	100	74	17	32	CNM.120408	D9900
F1T063X-PCLNRI12100	HSK T63 PCLNR 12 100-INTERNAL	25	100	74	17	32	CNM.120408	D9900
F1T063X-PCLNLI12120	HSK T63 PCLNL 12 120-INTERNAL	32	120	94	22	40	CNM.120408	D9900
F1T063X-PCLNRI12120	HSK T63 PCLNR 12 120-INTERNAL	32	120	94	22	40	CNM.120408	D9900
F1T063X-PCLNLI12140	HSK T63 PCLNL 12 140-INTERNAL	40	140	114	27	50	CNM.120408	D9900
F1T063X-PCLNRI12140	HSK T63 PCLNR 12 140-INTERNAL	40	140	114	27	50	CNM.120408	D9900

### PDUN

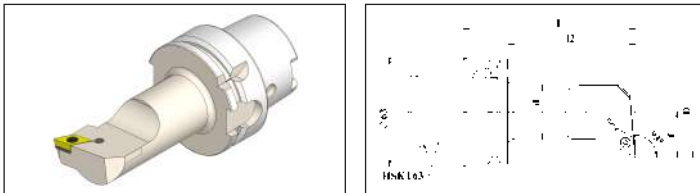

Note: Above shown images are Left Hand

Part No.	Product name	d.	l.	L2	f.	D	Inserts	Group
F1T063X-PDUNLI15120	HSK T63 PDUNL 15 120-INTERNAL	32	120	94	22	40	DN.150608	D9900
F1T063X-PDUNRI15120	HSK T63 PDUNR 15 120-INTERNAL	32	120	94	22	40	DN.150608	D9900
F1T063X-PDUNLI15140	HSK T63 PDUNL 15 140-INTERNAL	40	140	114	27	50	DN.150608	D9900
F1T063X-PDUNRI15140	HSK T63 PDUNR 15 140-INTERNAL	40	140	114	27	50	DN.150608	D9900

## INTERNAL BORING BARS-SCREW CLAMP

### SCLC

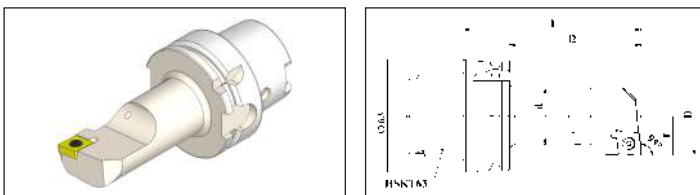

Note: Above shown images are Left Hand

Part No.	Product name	d.	l.	L2	f.	D	Inserts	Group
F1T063X-SCLCLI09085	HSK T63 SCLCL 09 085-INTERNAL	20	85	59	13	25	CC.09T308	D9900
F1T063X-SCLCRI09085	HSK T63 SCLCR 09 085-INTERNAL	20	85	59	13	25	CC.09T308	D9900
F1T063X-SCLCLI12100	HSK T63 SCLCL 12 100-INTERNAL	25	100	74	17	32	CC.120408	D9900
F1T063X-SCLCRI12100	HSK T63 SCLCR 12 100-INTERNAL	25	100	74	17	32	CC.120408	D9900



# HSK T63 (TURN MILL-MULTI TASK)

## SDUC

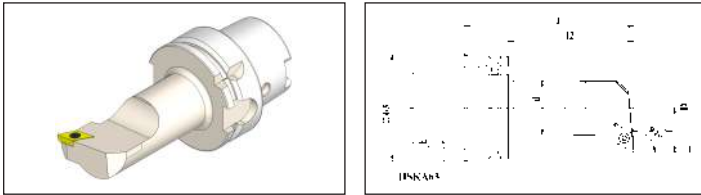

Note: Above shown images are Left Hand

Part No.	Product name	d.	l.	L2	f.	D	Inserts	Group
F1T063X-SDUCL11085	HSK T63 SDUCL 11 085-INTERNAL	20	85	59	13	25	DC.11T308	D9900
F1T063X-SDUCRI11085	HSK T63 SDUCR 11 085-INTERNAL	20	85	59	13	25	DC.11T308	D9900
F1T063X-SDUCL11100	HSK T63 SDUCL 11 100-INTERNAL	25	100	74	17	32	DC.11T308	D9900
F1T063X-SDUCRI11100	HSK T63 SDUCR 11 100-INTERNAL	25	100	74	17	32	DC.11T308	D9900
F1T063X-SDUCL11120	HSK T63 SDUCL 11 120-INTERNAL	32	120	94	22	40	DC.11T308	D9900
F1T063X-SDUCRI11120	HSK T63 SDUCR 11 120-INTERNAL	32	120	94	22	40	DC.11T308	D9900

## SVQB

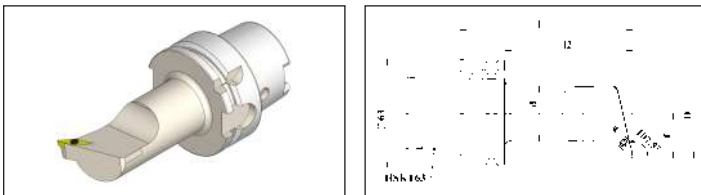

Note: Above shown images are Left Hand

Part No.	Product name	d.	l.	L2	f.	D	Inserts	Group
F1T063X-SVQBL16120	HSK T63 SVQBL 16 120-INTERNAL	32	120	94	22	40	VB.160408	D9900
F1T063X-SVQBR16120	HSK T63 SVQBR 16 120-INTERNAL	32	120	94	22	40	VB.160408	D9900
F1T063X-SVQBL16140	HSK T63 SVQBL 16 140-INTERNAL	40	140	114	27	50	VB.160408	D9900
F1T063X-SVQBR16140	HSK T63 SVQBR 16 140-INTERNAL	40	140	114	27	50	VB.160408	D9900

# HSK T63 (TURN MILL-MULTI TASK)

## AXIAL MOUNTING

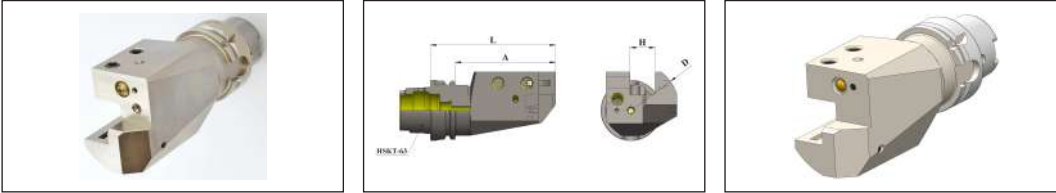

Note: Above shown images are Left Hand

Part No.	Product name	D	H	A	L	Kgs	Group
F1T063X-AL125131	HSK T63 AXIAL LEFT ONE SLOT SQ25 131	102	25	105	131	2.95	D9900
F1T063X-AR125131	HSK T63 AXIAL RIGHT ONE SLOT SQ25 131	102	25	105	131	3.010	D9900

## SPARES-SHIM

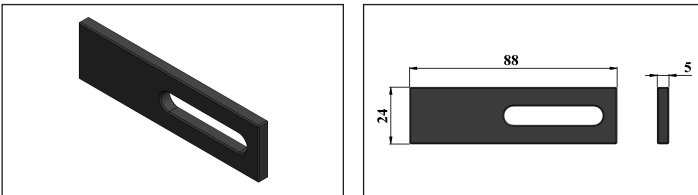

## RADIAL MOUNTING

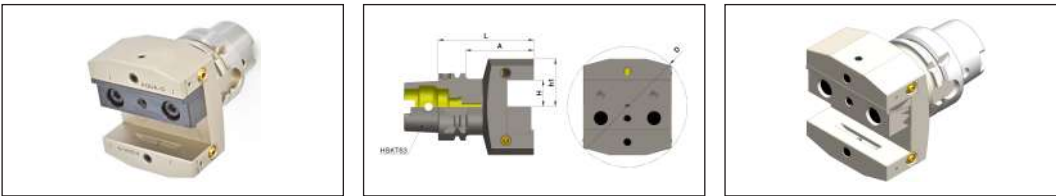

Part No.	Product name	H	h1	A	L	D	Kgs	Group
F1T063X-RCW25090	HSK T63 RADIAL COMINED WITH WEDGE SQ25 L090	25	45	64	90	112.6	2.93	D9900

## SPARES-WEDGES

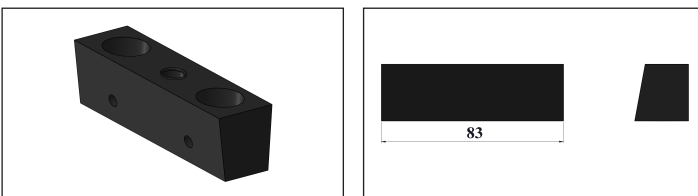

# HSK T63 (TURN MILL-MULTI TASK)

## ANGULAR MOUNTING 45°

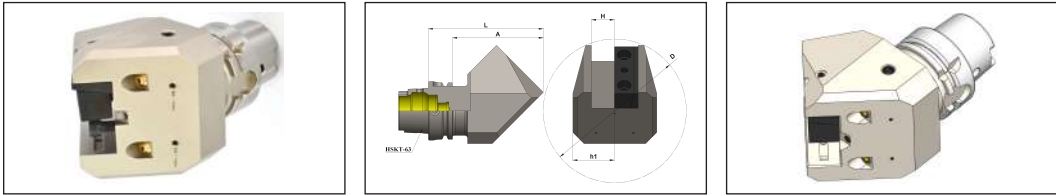

Part No.	Product name	H	h1	A	L	D	Kgs	Group
F1T063X-45W25123	HSK T63 WEDGE 45-DEGREE SQ25 L123	25	45	97.3	123.3	153.4	4.04	D9900

## SPARES-WEDGES

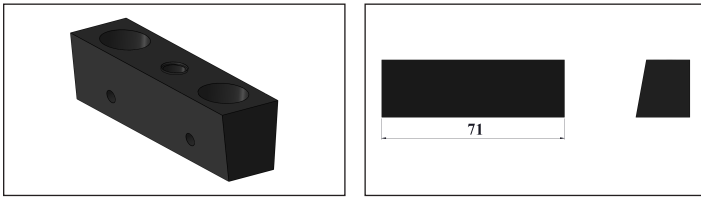

## AXIAL COMBINED MOUNTING

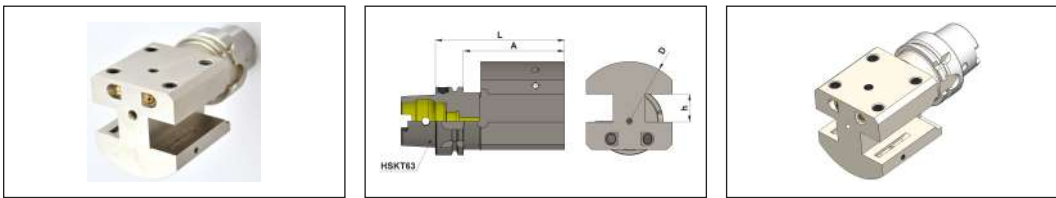

Part No.	Product name	A	D	L	H	Kgs	Group
F1T063X-AC225131	HSK T63 AXIAL COMBINED TWO SLOT SQ25 131	105	102	131	25	3.79	D9900

## SPARES-SHIM

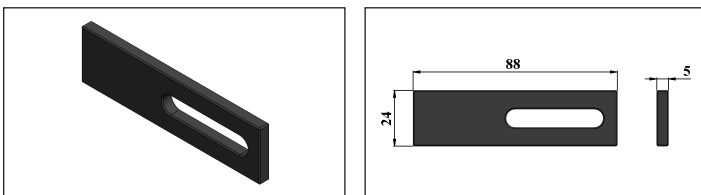

# HSK T63 (TURN MILL-MULTI TASK)

ADAPTORS FOR BORING BARS

## INDEXABLE DRILL/EM HOLDERS

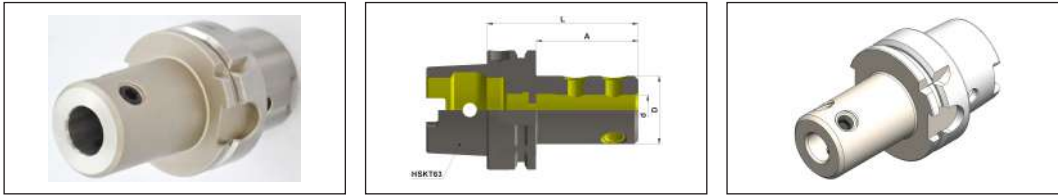

Part No.	Product name	D	d.	A	L	Screw	Kgs	Group
F1T063X-E1H16080	HSK T63 E1-TYPE EM HOLDER 16 080	36	16	54	80	M10X1X10	1.04	B2200
F1T063X-E1H20080	HSK T63 E1-TYPE EM HOLDER 20 080	40	20	54	80	M10X1X10	1.08	B2200
F1T063X-E1H25085	HSK T63 E1-TYPE EM HOLDER 25 085	45	25	59	85	M12X1X10	1.20	B2200
F1T063X-E1H32095	HSK T63 E1-TYPE EM HOLDER 32 095	52	32	69	95	M12X1X10	1.43	B2200
F1T063X-E1H40105	HSK T63 E1-TYPE EM HOLDER 40 105	65	40	79	105	M16X1X12	1.82	B2200
F1T063X-E1H50130	HSK T63 E1-TYPE EM HOLDER 50 130	75	50	104	130	M16X1X12	2.72	B2200

## BORING BAR HOLDERS

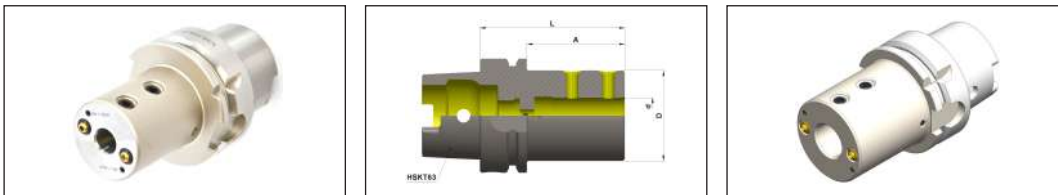

Part No.	Product name	D	d.	A	L	Screw	Kgs	Group
F1T063X-E2H06070	HSK T63 E2-TYPE EM HOLDER 06 070	32	6	44	70	M6X12	0.96	B2200
F1T063X-E2H08070	HSK T63 E2-TYPE EM HOLDER 08 070	32	8	44	70	M6X12	0.96	B2200
F1T063X-E2H10075	HSK T63 E2-TYPE EM HOLDER 10 075	38	10	49	75	M8X12	1.10	B2200
F1T063X-E2H12075	HSK T63 E2-TYPE EM HOLDER 12 075	40	12	49	75	M8X12	1.13	B2200
F1T063X-E2H16080	HSK T63 E2-TYPE EM HOLDER 16 080	45	16	54	80	M8X12	1.28	B2200
F1T063X-E2H20080	HSK T63 E2-TYPE EM HOLDER 20 080	50	20	54	80	M8X12	1.39	B2200
F1T063X-E2H25085	HSK T63 E2-TYPE EM HOLDER 25 085	55	25	59	85	M10X12	1.54	B2200
F1T063X-E2H32095	HSK T63 E2-TYPE EM HOLDER 32 095	72	32	69	95	M10X20	2.29	B2200
F1T063X-E2H40120	HSK T63 E2-TYPE EM HOLDER 40 120	80	40	94	120	M10X20	3.33	B2200

## BORING BAR HOLDERS FOR DAMPED TOOLS

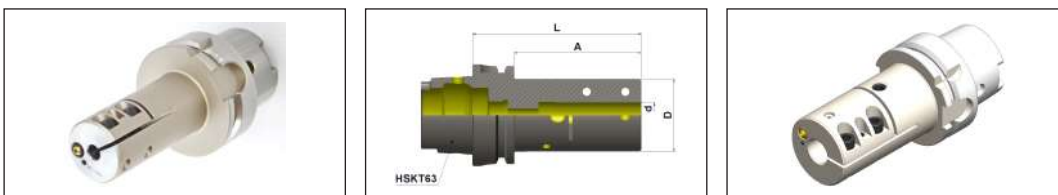

Part No.	Product name	D	d.	A	L	Screw	Kgs	Group
F1T063X-EMT06100	HSK T63 EM HOLDER WITH SLITTING 06 100	32	6	74	100	M5X16	1.13	B2200
F1T063X-EMT08100	HSK T63 EM HOLDER WITH SLITTING 08 100	34	8	74	100	M5X16	1.20	B2200
F1T063X-EMT10100	HSK T63 EM HOLDER WITH SLITTING 10 100	45	10	74	100	M6X16	1.56	B2200
F1T063X-EMT12100	HSK T63 EM HOLDER WITH SLITTING 12 100	45	12	74	100	M6X16	1.54	B2200
F1T063X-EMT16105	HSK T63 EM HOLDER WITH SLITTING 16 105	45	16	79	105	M6X16	1.55	B2200
F1T063X-EMT20110	HSK T63 EM HOLDER WITH SLITTING 20 110	53	20	84	110	M6X20	1.92	B2200
F1T063X-EMT25130	HSK T63 EM HOLDER WITH SLITTING 25 130	53	25	104	130	M6X20	2.06	B2200
F1T063X-EMT32155	HSK T63 EM HOLDER WITH SLITTING 32 155	63	32	129	155	M8X20	2.82	B2200
F1T063X-EMT40187	HSK T63 EM HOLDER WITH SLITTING 40 187	70	40	161	187	M8X20	4.07	B2200



# ***Falcon Toolings***

SF. No. 205 / 1 & 2, Kalapatti, Coimbatore - 641 048, India

Ph : +91 (422) 266 6156 , +91 (422) 266 6322

Email : [sales@falcontoolings.com](mailto:sales@falcontoolings.com)

Web: [www.falcontoolings.com](http://www.falcontoolings.com)